

Instruction for installing 1997-2007 FORD F-Series SuperDuty Truck/Excursion/Econoline Mirror Main Glass Assemblies with Jack Screws

Questions: Send email to Support@dfuser.com

**dfuser.com
108 Evergreen Road
Georgetown, TX 78628-9500**

KIT - 4C3Z-17K707-EA		
Part Number	Description	Quantity
3C34-17A700-AA	Main Glass Assembly F-Series Super Duty/ Heated (Right Hand)	1
4C34-17E724-AA	Jackscrew Kit	1
SK-4C34-17A721-AA	Instruction Sheet	1

KIT - 4C3Z-17K707-FA		
Part Number	Description	Quantity
3C34-17C718-BA	Main Glass Assembly F-Series Super Duty/ Heated (Left Hand)	1
4C34-17E724-AA	Jackscrew Kit	1
SK-4C34-17A721-AA	Instruction Sheet	1

KIT - 4C3Z-17K707-GA		
Part Number	Description	Quantity
4C34-17E724-AA	Jackscrew Kit	1
SK-4C34-17A721-AA	Instruction Sheet	1

SERVICE PROCEDURE:

NOTE: Repair procedure to replace the Main Glass and Backing Plate assembly in the Left Hand and Right Hand manual, Electric and Heated Electric Trailer Tow and Telescopic Trailer Tow Mirrors.

Removal:

NOTE: Left-hand dual arm mirror with heat shown, non-heated mirrors similar.

All Exterior Mirrors

1. Position the exterior mirror glass backing plate assembly in the full down position (refer to Figure 1).
2. Grasp the top and carefully pull the exterior mirror glass backing plate assembly away from the mirror housing.
3. Disconnect the electrical terminals (if equipped) and remove the exterior mirror glass backing plate assembly (refer to Figure 2).
4. Remove the jackscrews from the exterior mirror glass backing plate assembly (refer to Figure 3).
 - Use pliers to grasp the jackscrews at the base to remove.



CPR © 2004 FORD MOTOR COMPANY
DEARBORN, MICHIGAN 48121
5-04

SK-4C34-17A721-AA SHEET 2 OF 5

INSTRUCTIONS FOR INSTALLING 1997 - 2004
F-SERIES SUPER DUTY TRUCK/EXCURSION/
ECONOLINE MIRROR MAIN GLASS ASSEMBLIES
WITH JACKSCREWS

INSTALLATION:

Power Exterior Mirrors

1. Remove the sealing boots from the exterior mirror motors inside the mirror housing (refer to Figure 4).
2. Remove the new jackscrews from their kit's plastic bag. Separate and discard the protective gear carriers from the jackscrews. Install the jackscrews in the sealing boots (refer to Figure 5).
3. To install the jackscrews and sealing boots (refer to Figure 6).
 - Hold the legs of the jackscrews together and push the jackscrews back into motors inside the exterior mirror housing.
 - Install the sealing boots so the boot shoulders are under the motor collars and turn each jackscrew until its head is aligned with the slot in the socket on the rear surface of the new glass backing plate assembly.

All Exterior Mirrors

4. Place the new exterior mirror glass backing plate assembly, mirror side down, on a smooth firm surface.
5. Remove the friction pins taped to the back of the mirror glass backing plate assembly. Align the friction pins vertically to the exterior mirror glass backing plate assembly's sockets and push down to snap the friction pins pivot balls into the sockets (refer to Figure 7).
6. Using the special tool, warm the main pivot sockets in the exterior mirror glass backing plate assembly (refer to Figure 8).

CAUTION: DO NOT OVERHEAT THE EXTERIOR MIRROR GLASS BACKING PLATE ASSEMBLY. HEAT ONLY UNTIL THE BACKING PLATE ASSEMBLY IS WARM TO THE TOUCH.

7. To loosely install the glass mirror backing plate assembly (refer to Figure 9).
 - Connect the electrical wiring to the electrical terminals (if equipped).
 - Position the friction pins in the mirror housing.
 - Align the jackscrew locating tabs to match the slots in the sockets on the mirror glass backing plate assembly.
8. Using a flat hand, press on the center of the mirror glass backing plate assembly until seated on the center pivot of the mirror housing.
 - Press the mirror glass backing plate assembly toward one of the jackscrews until it snaps into place.
 - Repeat for second jackscrew.



CPR © 2004 FORD MOTOR COMPANY
DEARBORN, MICHIGAN 48121
5-04

SK-4C34-17A721-AA

SHEET 3 OF 5

INSTRUCTIONS FOR INSTALLING 1997 - 2004
F-SERIES SUPER DUTY TRUCK/EXCURSION/
ECONOLINE MIRROR MAIN GLASS ASSEMBLIES
WITH JACKSCREWS

NOTE: If the jackscrews do not engage, they may not be aligned correctly. Remove the exterior mirror glass backing plate assembly, align the jackscrews to the slots in the sockets and repeat the installation procedure.

Power Exterior Mirrors

NOTE: The jackscrew should click while manually adjusting the exterior mirror glass backing plate assembly.

- Tilt the exterior mirror glass backing plate assembly to the full outboard position and then press on the outer side of the glass until the in/out jackscrew snaps into the socket on the exterior mirror backing plate assembly.

NOTE: The jackscrew should click while manually adjusting the exterior mirror glass backing plate assembly.

- Tilt the exterior mirror glass backing plate assembly to the full down position and then press on the outer side of the glass until the up/down jackscrew snaps into the socket on the exterior mirror backing plate assembly.

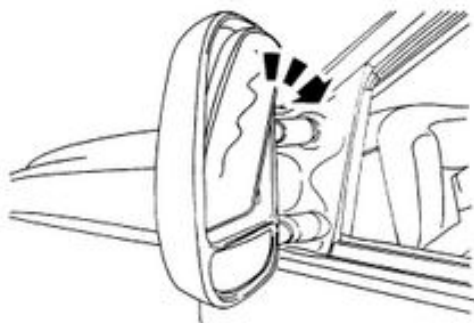

FIGURE 1



FIGURE 2

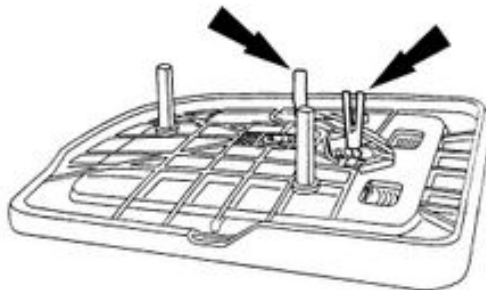

FIGURE 3

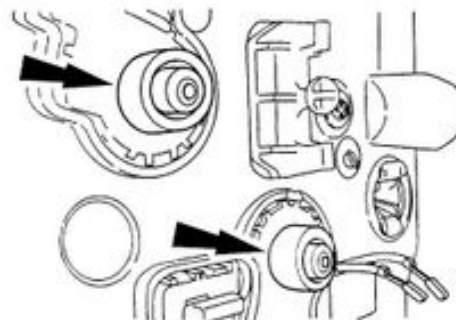

FIGURE 4



CPR © 2004 FORD MOTOR COMPANY
DEARBORN, MICHIGAN 48121
5-04

SK-4C34-17A721-AA

SHEET 4 OF 5

INSTRUCTIONS FOR INSTALLING 1997 - 2004
F-SERIES SUPER DUTY TRUCK/EXCURSION/
ECONOLINE MIRROR MAIN GLASS ASSEMBLIES
WITH JACKSCREWS

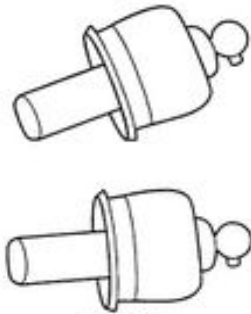

FIGURE 5

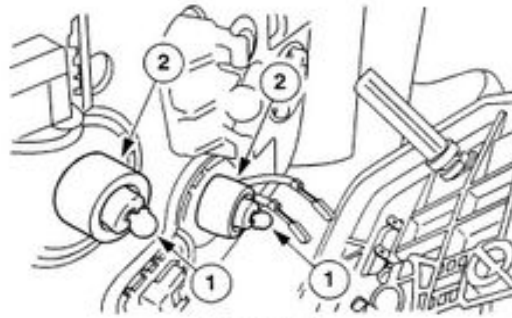

FIGURE 6

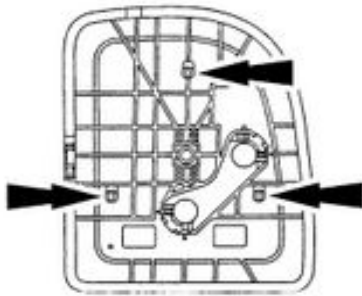

FIGURE 7

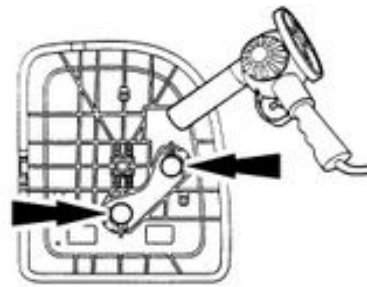

FIGURE 8

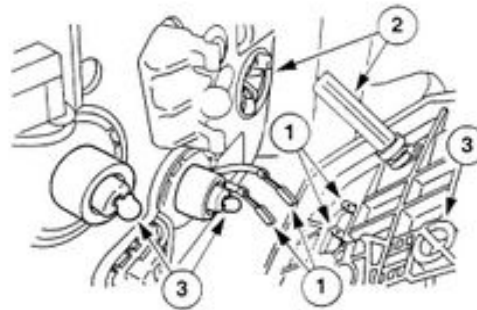

FIGURE 9



CPR © 2004 FORD MOTOR COMPANY
 DEARBORN, MICHIGAN 48121
 5-04

SK-4C34-17A721-AA

SHEET 5 OF 5

INSTRUCTIONS FOR INSTALLING 1997 - 2004
 F-SERIES SUPER DUTY TRUCK/EXCURSION/
 ECONOLINE MIRROR MAIN GLASS ASSEMBLIES
 WITH JACKSCREWS